

# PFS

## Planet Flat - Plain Ram Spring Return – Single Acting

### ADVANTAGES / FEATURES

- Compact & Flat design ideally / suited where Clearance is minimum for insertion of jack.
- Mounting Holes for easy fixturing
- Stacking plate to increase closed height is optional.
- Hard Chrome Plate Ram and Cylinder to resist scoring and corrosion.
- High Pressure working Oil Seals are used.
- Heavy equipment Lifting, Alignment & Clamping. Ensure no gap Between jack & Load to be lifted, to utilize full stroke.

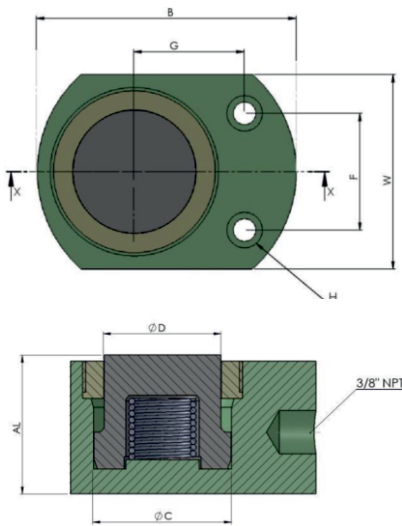

Model	Mounting Hole Location (in MM)		
	"F"	"G"	"Thru Hole" H"
PFS 5 - 10	28	25	5.5
PFS 10 - 12	36	35	7
PFS 20 - 12	50	40	8.5
PFS 30 - 12	55	45	10.5
PFS 50 - 16	75	55	11
PFS 75 - 16	85	70	13
PFS 100 - 16	90	80	13
PFS 150 - 16	110	95	13
PFS 200 - 16	130	105	17



### NOTE:

- Customized Tonnage and strokes are manufactured as per customer requirement.
- Capacity and Stroke specified are under safety factors.
- While using please read the instructions/manual .
- Use at 75% of rating as safe practice.

**PFS Series - P:** Planet, **F:** Flat Jack, **S:** Single acting return, **10:** Capacity - ton, **12:** Stroke - mm

Model	Cap. in (ton)	Cap. in (kN)	Stroke in (mm)	"A" Close Height	Effective area in (cm <sup>2</sup> )	Oil Cap in (cc)	"B" Cylinder OD	"W" A/F in (mm)	"C" Cyl Bore ID	"D" Ram dia.	wt. Approx in kg
PFS 10-12	10	111	12	45	15.9	19	80	60	45	35	1.3
PFS 20-12	20	217	12	55	31.2	37	100	80	63	50	2.6
PFS 30-12	30	310	12	60	44.2	53	115	95	75	60	3.8
PFS 50-16	50	551	16	65	78.5	126	140	120	100	70	6.2
PFS 75-16	75	792	16	80	113.1	181	175	145	120	85	11.8
PFS 100-16	100	1078	16	85	153.9	247	190	165	140	100	15.1
PFS 150-16	150	1590	16	100	227.0	363	230	205	170	120	27.0
PFS 200-16	200	1985	16	115	283.5	454	265	230	190	140	40.7

- Specifications are subject to change due to continual improvement.
- Higher capacity and customized solution on request.
- Capacity and Stroke specified are maximum safe limits. Use at 80% of rating as safe practice.

